

ROTARY NUMBERING MACHINE PARTS

- *Convex* -

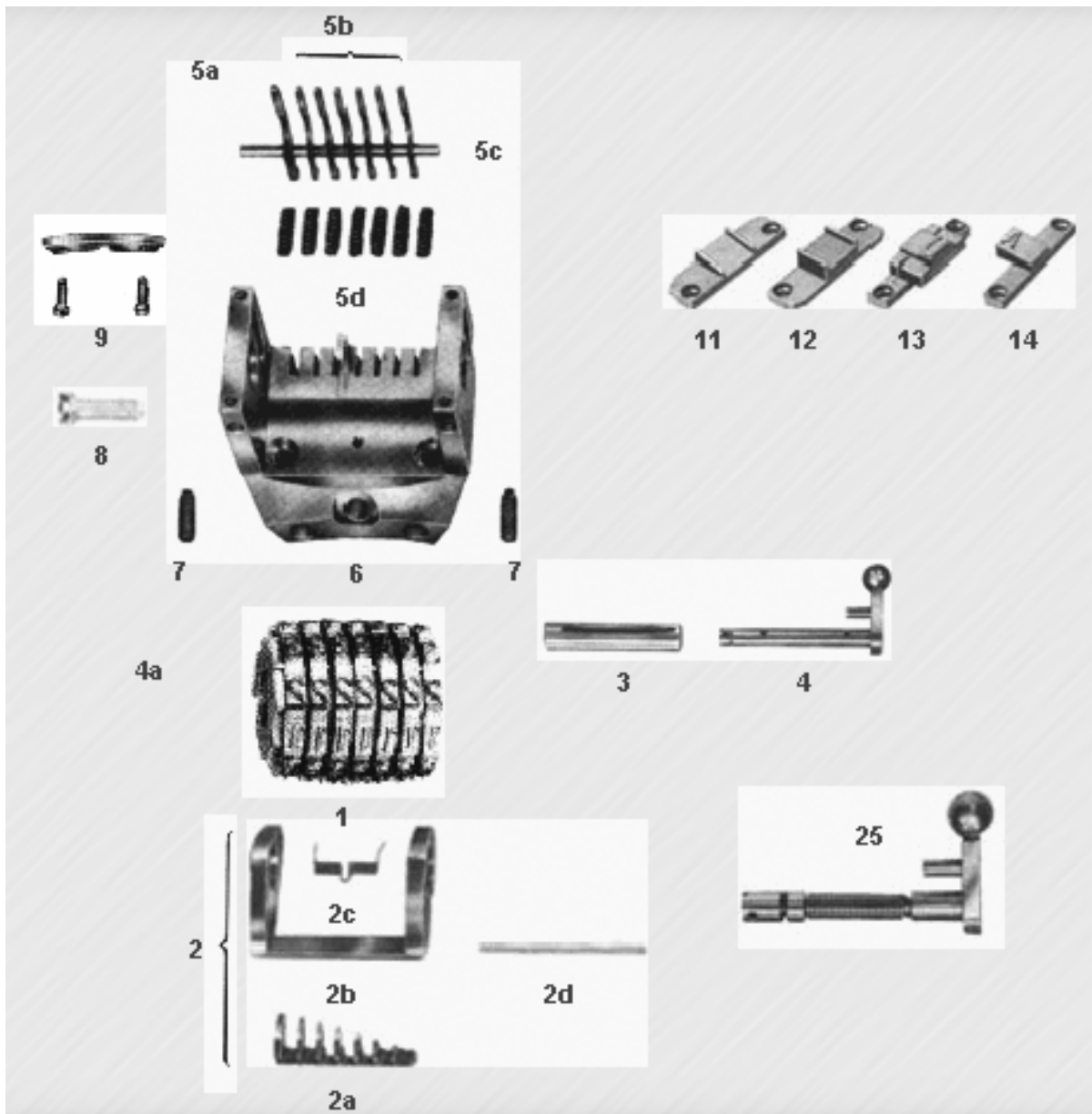

Rotary Numbering machine Parts - Convex

- 1 Set of wheels (consists of Unit wheel & Tens wheel with sinkable zeros 2nd--7th pos.
- 2 Complete swing
- 2a Actuating Pawl
- 2b Swing only
- 2c Actuating Pawl spring
- 2d Actuating Pawl shaft
- 3 Tube shaft
- 4 Operating arm
- 4a E-ring
- 5a Unit retaining Pawl
- 5b Tens retaining Pawl 2nd--7th position
- 5c Retaining Pawl shaft
- 5d Retaining Pawl spring set (consists of 5a, 5b, 5c and 5d)
- 6 Frame
- 7 Shaft set screw
- 8 Gib locking screw
- 9 Gib holding screw (2 per set)
- 10 Gib
- 11 Convex Die for rubber slide
- 12 Straight Die for rubber slide
- 13 Straight Die with interchangeable slide
- 14 Convex Die with engraved slide
- 26 Straight operating arms, spring return, specify either Unit or prefix side